

MOVE IT

8 - 10 March 2019, ExCeL - London

MOVE IT
Entrance
S5

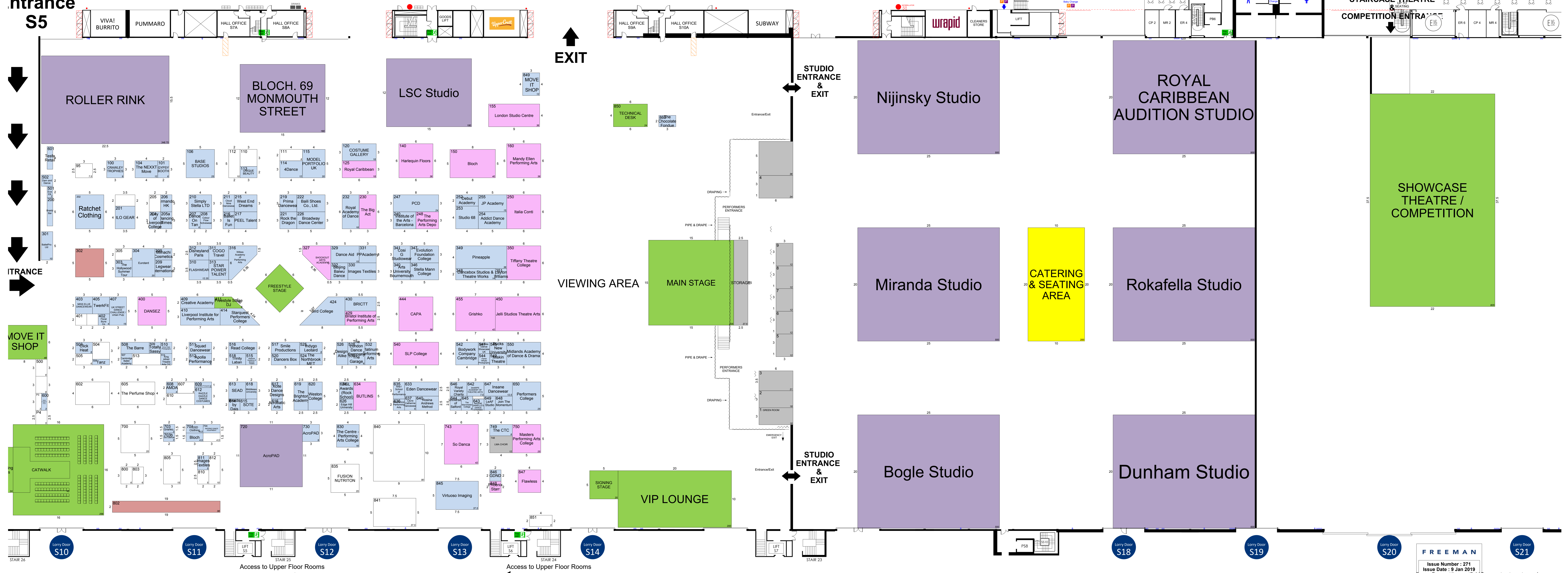

ENTRANCE

MOVE IT SHOP

Lorry Door S10 Lorry Door S11 Lorry Door S12 Lorry Door S13 Lorry Door S14 Lorry Door S18 Lorry Door S19 Lorry Door S20 Lorry Door S21

Access to Upper Floor Rooms Access to Upper Floor Rooms

MOVE IT PRO
MOVE FIT
CONTEMPORARY STUDIO
HARLEQUIN MASTERCLASS STUDIO
PERFORMANCE WORKSHOP
UPSTAIRS
ROOMS

FREEMAN
Issue Number : 271
Issue Date : 9 Jan 2019
Drawn By : matthew.gatfield@upperstreetevents.co.uk
Scale : N.T.S.
THIS FLOORPLAN IS SUBJECT TO APPROVAL FROM THE VENUE AND LOCAL AUTHORITIES

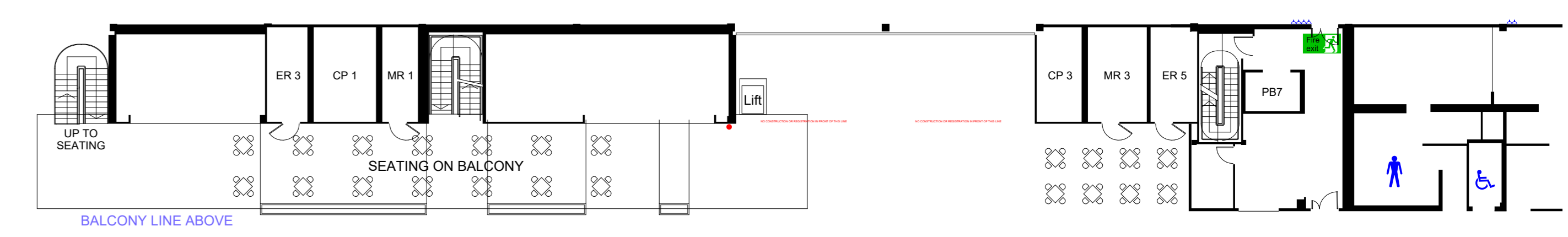

EXIT

STUDIO ENTRANCE & EXIT

STUDIO ENTRANCE & EXIT

STAIRCASE THEATRE
&
COMPETITION ENTRANCE

VIEWING AREA

MAIN STAGE

CATERING &
SEATING
AREA

SHOWCASE
THEATRE /
COMPETITION

ROLLER RINK

BLOCH. 69
MONMOUTH
STREET

LSC Studio

Nijinsky Studio

ROYAL
CARIBBEAN
AUDITION STUDIO

Miranda Studio

Rokafella Studio

Bogle Studio

Dunham Studio

VIP LOUNGE

- 601 Test
- 100 OSAMULET TROPHIES
- 104 The NEXT Move
- 105 THE BOOTH
- 106 BASE STUDIOS
- 112 1110
- 114 4Dance
- 115 MODEL PORTFOLIO UK
- 118 118 BEAUTY
- 120 COSTUME GALLERY
- 125 125 Royal Caribbean
- 140 Harlequin Floors
- 150 Bloch
- 160 Mandy Ellen Performing Arts
- 201 Ratchet Clothing
- 205 ILO GEAR
- 206 206 HK
- 210 Simply Stella LTD
- 211 211 West End Dreams
- 219 219 Simply Dancewear
- 221 221 Rock the Dragon
- 222 222 Ball Shoes Co., Ltd.
- 232 232 Royal The Big Act
- 233 233 The Academy of Dance
- 234 234 Studio 66
- 235 235 JP Academy
- 236 236 Addid Dance Academy
- 237 237 PCD
- 238 238 The Performing Arts Diplo
- 248 248 Italia Conti
- 302 Ratchet Clothing
- 303 303 ILO GEAR
- 304 304 304
- 305 305 305
- 306 306 306
- 307 307 307
- 308 308 308
- 309 309 309
- 310 310 310
- 311 311 311
- 312 312 312
- 313 313 313
- 314 314 314
- 315 315 315
- 316 316 316
- 317 317 317
- 318 318 318
- 319 319 319
- 320 320 320
- 321 321 321
- 322 322 322
- 323 323 323
- 324 324 324
- 325 325 325
- 326 326 326
- 327 327 327
- 328 328 328
- 329 329 329
- 330 330 330
- 331 331 331
- 332 332 332
- 333 333 333
- 334 334 334
- 335 335 335
- 336 336 336
- 337 337 337
- 338 338 338
- 339 339 339
- 340 340 340
- 341 341 341
- 342 342 342
- 343 343 343
- 344 344 344
- 345 345 345
- 346 346 346
- 347 347 347
- 348 348 348
- 349 349 349
- 350 350 350
- 400 DANSEZ
- 401 401 401
- 402 402 402
- 403 403 403
- 404 404 404
- 405 405 405
- 406 406 406
- 407 407 407
- 408 408 408
- 409 409 409
- 410 410 410
- 411 411 411
- 412 412 412
- 413 413 413
- 414 414 414
- 415 415 415
- 416 416 416
- 417 417 417
- 418 418 418
- 419 419 419
- 420 420 420
- 421 421 421
- 422 422 422
- 423 423 423
- 424 424 424
- 425 425 425
- 426 426 426
- 427 427 427
- 428 428 428
- 429 429 429
- 430 430 430
- 431 431 431
- 432 432 432
- 433 433 433
- 434 434 434
- 435 435 435
- 436 436 436
- 437 437 437
- 438 438 438
- 439 439 439
- 440 440 440
- 441 441 441
- 442 442 442
- 443 443 443
- 444 444 444
- 445 445 445
- 446 446 446
- 447 447 447
- 448 448 448
- 449 449 449
- 450 450 450
- 451 451 451
- 452 452 452
- 453 453 453
- 454 454 454
- 455 455 455
- 456 456 456
- 457 457 457
- 458 458 458
- 459 459 459
- 460 460 460
- 461 461 461
- 462 462 462
- 463 463 463
- 464 464 464
- 465 465 465
- 466 466 466
- 467 467 467
- 468 468 468
- 469 469 469
- 470 470 470
- 471 471 471
- 472 472 472
- 473 473 473
- 474 474 474
- 475 475 475
- 476 476 476
- 477 477 477
- 478 478 478
- 479 479 479
- 480 480 480
- 481 481 481
- 482 482 482
- 483 483 483
- 484 484 484
- 485 485 485
- 486 486 486
- 487 487 487
- 488 488 488
- 489 489 489
- 490 490 490
- 491 491 491
- 492 492 492
- 493 493 493
- 494 494 494
- 495 495 495
- 496 496 496
- 497 497 497
- 498 498 498
- 499 499 499
- 500 500 500

MOVE IT PRO
MOVE FIT
CONTEMPORARY STUDIO
HARLEQUIN MASTERCLASS STUDIO
PERFORMANCE WORKSHOP
UPSTAIRS
ROOMS

FREEMAN
Issue Number : 271
Issue Date : 9 Jan 2019
Drawn By : matthew.gatfield@upperstreetevents.co.uk
Scale : N.T.S.
THIS FLOORPLAN IS SUBJECT TO APPROVAL FROM THE VENUE AND LOCAL AUTHORITIES